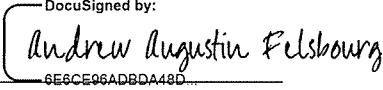
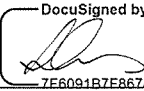

Vendor Statement

The vendor makes this statement in respect of the land in accordance with section 32 of the *Sale of Land Act 1962*.
This statement must be signed by the vendor and given to the purchaser before the purchaser signs the contract.
The vendor may sign by electronic signature.
The purchaser acknowledges being given this statement signed by the vendor with the attached documents before the purchaser signed any contract.

Land	8 LACY STREET, SELBY VIC 3159
------	-------------------------------

Vendor's name	Andrew Augustin Felsbourg	Date
Vendor's signature		5/6/2024
	<div>DocuSigned by:  6E6CE96ADBDA48D...</div>	
Vendor's name	Louisa Margarita Felsbourg	Date
Vendor's signature		5/6/2024
	<div>DocuSigned by:  7F6091B7F8674AD...</div>	

Purchaser's name	Date
Purchaser's signature	
Purchaser's name	Date
Purchaser's signature	

1. FINANCIAL MATTERS

1.1 Particulars of any Rates, Taxes, Charges or Other Similar Outgoings (and any interest on them)

Are contained in the attached certificates.

1.2 Particulars of any Charge (whether registered or not) imposed by or under any Act to secure an amount due under that Act, including the amount owing under the charge

To the best of the vendors knowledge there are no such charges. However, the vendor has no means of knowing all charges that may be imposed on the property under any Act unless they are communicated to the vendor.

1.3 Terms Contract

This section 1.3 only applies if this vendor statement is in respect of a terms contract where the purchaser is obliged to make 2 or more payments (other than a deposit or final payment) to the vendor after the execution of the contract and before the purchaser is entitled to a conveyance or transfer of the land.

Not applicable

1.4 Sale Subject to Mortgage

This section 1.4 only applies if this vendor statement is in respect of a contract which provides that any mortgage (whether registered or unregistered), is NOT to be discharged before the purchaser becomes entitled to possession or receipts of rents and profits.

Not applicable

2. INSURANCE

2.1 Damage and Destruction

This section 2.1 only applies if this vendor statement is in respect of a contract which does NOT provide for the land to remain at the risk of the vendor until the purchaser becomes entitled to possession or receipt of rents and profits.

Not applicable

2.2 Owner Builder

This section 2.2 only applies where there is a residence on the land that was constructed by an owner-builder within the preceding 6 years and section 137B of the Building Act 1993 applies to the residence.

Not applicable

3. LAND USE

3.1 Easements, Covenants or Other Similar Restrictions

- (a) A description of any easement, covenant or other similar restriction affecting the land (whether registered or unregistered):

Is in the attached copies of title documents.

- (b) Particulars of any existing failure to comply with that easement, covenant or other similar restriction are:

To the best of the Vendor's knowledge there is no existing failure to comply with the terms of any easements, covenants or other similar restriction.

3.2 Road Access

There is NO access to the property by road if the square box is marked with an 'X'

☐

3.3 Designated Bushfire Prone Area

The land is in a designated bushfire prone area within the meaning of regulations made under the *Building Act* 1993 if the square box is marked with an 'X'

☐

3.4 Planning Scheme

Attached is a certificate with the required specified information.

4. NOTICES**4.1 Notice, Order, Declaration, Report or Recommendation**

Particulars of any notice, order, declaration, report or recommendation of a public authority or government department or approved proposal directly and currently affecting the land, being a notice, order, declaration, report, recommendation or approved proposal of which the vendor might reasonably be expected to have knowledge:

None to the knowledge of the vendor

4.2 Agricultural Chemicals

There are NO notices, property management plans, reports or orders in respect of the land issued by a government department or public authority in relation to livestock disease or contamination by agricultural chemicals affecting the ongoing use of the land for agricultural purposes. However, if this is not the case, the details of any such notices, property management plans, reports or orders, are as follows:

Nil

4.3 Compulsory Acquisition

The particulars of any notices of intention to acquire that have been served under section 6 of the *Land Acquisition and Compensation Act* 1986 are as follows:

Nil

5. BUILDING PERMITS

Particulars of any building permit issued under the *Building Act* 1993 in the preceding 7 years (required only where there is a residence on the land):

Are contained in the attached certificate.

6. OWNERS CORPORATION

This section 6 only applies if the land is affected by an owners corporation within the meaning of the *Owners Corporations Act* 2006.

Not applicable

7. GROWTH AREAS INFRASTRUCTURE CONTRIBUTION ("GAIC")

Words and expressions in this section 7 have the same meaning as in Part 9B of the *Planning and Environment Act* 1987.

Not applicable

8. SERVICES

The services which are marked with an 'X' in the accompanying square box are NOT connected to the land:

Electricity supply <input type="checkbox"/>	Gas supply <input type="checkbox"/>	Water supply <input checked="" type="checkbox"/>	Sewerage <input checked="" type="checkbox"/>	Telephone services <input checked="" type="checkbox"/>
---	-------------------------------------	--	--	--

9. TITLE

Attached are copies of the following documents:

9.1 ☒ (a) Registered Title

A Register Search Statement and the document, or part of a document, referred to as the "diagram location" in that statement which identifies the land and its location.

10. SUBDIVISION**10.1 Unregistered Subdivision**

This section 10.1 only applies if the land is subject to a subdivision which is not registered.

Not applicable

10.2 Staged Subdivision

This section 10.2 only applies if the land is part of a staged subdivision within the meaning of section 37 of the *Subdivision Act 1988*.

Not applicable

10.3 Further Plan of Subdivision

This section 10.3 only applies if the land is subject to a subdivision in respect of which a further plan within the meaning of the *Subdivision Act 1988* is proposed.

Not applicable

11. DISCLOSURE OF ENERGY INFORMATION

(Disclosure of this information is not required under section 32 of the Sale of Land Act 1962 but may be included in this vendor statement for convenience.)

Details of any energy efficiency information required to be disclosed regarding a disclosure affected building or disclosure area affected area of a building as defined by the *Building Energy Efficiency Disclosure Act 2010* (Cth)

- (a) to be a building or part of a building used or capable of being used as an office for administrative, clerical, professional or similar based activities including any support facilities; and
- (b) which has a net lettable area of at least 2000m²; (but does not include a building under a strata title system or if an occupancy permit was issued less than 2 years before the relevant date):

Not applicable

12. DUE DILIGENCE CHECKLIST

(The Sale of Land Act 1962 provides that the vendor or the vendor's licensed estate agent must make a prescribed due diligence checklist available to purchasers before offering land for sale that is vacant residential land or land on which there is a residence. The due diligence checklist is NOT required to be provided with, or attached to, this vendor statement but the checklist may be attached as a matter of convenience.)

Is attached.

13. ATTACHMENTS

(Any certificates, documents and other attachments may be annexed to this section 13)

(Additional information may be added to this section 13 where there is insufficient space in any of the earlier sections)

(Attached is an "Additional Vendor Statement" if section 1.3 (Terms Contract) or section 1.4 (Sale Subject to Mortgage) applies)

Due diligence checklist

What you need to know before buying a residential property

Before you buy a home, you should be aware of a range of issues that may affect that property and impose restrictions or obligations on you, if you buy it. This checklist aims to help you identify whether any of these issues will affect you. The questions are a starting point only and you may need to seek professional advice to answer some of them. You can find links to organisations and web pages that can help you learn more, by visiting the [Due diligence checklist page on the Consumer Affairs Victoria website](https://consumer.vic.gov.au/duediligencechecklist) (consumer.vic.gov.au/duediligencechecklist).

Urban living

Moving to the inner city?

High density areas are attractive for their entertainment and service areas, but these activities create increased traffic as well as noise and odours from businesses and people. Familiarising yourself with the character of the area will give you a balanced understanding of what to expect.

Is the property subject to an owners corporation?

If the property is part of a subdivision with common property such as driveways or grounds, it may be subject to an owners corporation. You may be required to pay fees and follow rules that restrict what you can do on your property, such as a ban on pet ownership.

Growth areas

Are you moving to a growth area?

You should investigate whether you will be required to pay a growth areas infrastructure contribution.

Flood and fire risk

Does this property experience flooding or bushfire?

Properties are sometimes subject to the risk of fire and flooding due to their location. You should properly investigate these risks and consider their implications for land management, buildings and insurance premiums.

Rural properties

Moving to the country?

If you are looking at property in a rural zone, consider:

- Is the surrounding land use compatible with your lifestyle expectations? Farming can create noise or odour that may be at odds with your expectations of a rural lifestyle.
- Are you considering removing native vegetation? There are regulations which affect your ability to remove native vegetation on private property.
- Do you understand your obligations to manage weeds and pest animals?

Can you build new dwellings?

Does the property adjoin crown land, have a water frontage, contain a disused government road, or are there any crown licences associated with the land?

Is there any earth resource activity such as mining in the area?

You may wish to find out more about exploration, mining and quarrying activity on or near the property and consider the issue of petroleum, geothermal and greenhouse gas sequestration permits, leases and licences, extractive industry authorisations and mineral licences.

Soil and groundwater contamination

Has previous land use affected the soil or groundwater?

You should consider whether past activities, including the use of adjacent land, may have caused contamination at the site and whether this may prevent you from doing certain things to or on the land in the future.

Land boundaries

Do you know the exact boundary of the property?

You should compare the measurements shown on the title document with actual fences and buildings on the property, to make sure the boundaries match. If you have concerns about this, you can speak to your lawyer or conveyancer, or commission a site survey to establish property boundaries.

Planning controls

Can you change how the property is used, or the buildings on it?

All land is subject to a planning scheme, run by the local council. How the property is zoned and any overlays that may apply, will determine how the land can be used. This may restrict such things as whether you can build on vacant land or how you can alter or develop the land and its buildings over time.

The local council can give you advice about the planning scheme, as well as details of any other restrictions that may apply, such as design guidelines or bushfire safety design. There may also be restrictions – known as encumbrances – on the property's title, which prevent you from developing the property. You can find out about encumbrances by looking at the section 32 statement.

Are there any proposed or granted planning permits?

The local council can advise you if there are any proposed or issued planning permits for any properties close by. Significant developments in your area may change the local 'character' (predominant style of the area) and may increase noise or traffic near the property.

Safety

Is the building safe to live in?

Building laws are in place to ensure building safety. Professional building inspections can help you assess the property for electrical safety, possible illegal building work, adequate pool or spa fencing and the presence of asbestos, termites, or other potential hazards.

Building permits

Have any buildings or retaining walls on the property been altered, or do you plan to alter them?

There are laws and regulations about how buildings and retaining walls are constructed, which you may wish to investigate to ensure any completed or proposed building work is approved. The local council may be able to give you information about any building permits issued for recent building works done to the property, and what you must do to plan new work. You can also commission a private building surveyor's assessment.

Are any recent building or renovation works covered by insurance?

Ask the vendor if there is any owner-builder insurance or builder's warranty to cover defects in the work done to the property.

Utilities and essential services

Does the property have working connections for water, sewerage, electricity, gas, telephone and internet?

Unconnected services may not be available, or may incur a fee to connect. You may also need to choose from a range of suppliers for these services. This may be particularly important in rural areas where some services are not available.

Buyers' rights

Do you know your rights when buying a property?

The contract of sale and section 32 statement contain important information about the property, so you should request to see these and read them thoroughly. Many people engage a lawyer or conveyancer to help them understand the contracts and ensure the sale goes through correctly. If you intend to hire a professional, you should consider speaking to them before you commit to the sale. There are also important rules about the way private sales and auctions are conducted. These may include a cooling-off period and specific rights associated with 'off the plan' sales. The important thing to remember is that, as the buyer, you have rights.



Copyright State of Victoria. No part of this publication may be reproduced except as permitted by the Copyright Act 1968 (Cth), to comply with a statutory requirement or pursuant to a written agreement. The information is only valid at the time and in the form obtained from the LANDATA REGD TM System. None of the State of Victoria, its agents or contractors, accepts responsibility for any subsequent publication or reproduction of the information.

The Victorian Government acknowledges the Traditional Owners of Victoria and pays respects to their ongoing connection to their Country, History and Culture. The Victorian Government extends this respect to their Elders, past, present and emerging.

REGISTER SEARCH STATEMENT (Title Search) Transfer of Land Act 1958

Page 1 of 1

VOLUME 09376 FOLIO 712

Security no : 124114865423H
Produced 10/05/2024 04:15 PM

LAND DESCRIPTION

Land in Plan of Consolidation 150144.

PARENT TITLES :

Volume 09101 Folio 541 Volume 09369 Folio 758

Created by instrument CP150144 24/06/1980

REGISTERED PROPRIETOR

Estate Fee Simple

TENANTS IN COMMON

As to 1 of a total of 2 equal undivided shares

Sole Proprietor

ANDREW AUGUSTIN FELSBOURG of 8 LACY STREET SELBY VIC 3159

As to 1 of a total of 2 equal undivided shares

Sole Proprietor

LOUISA MARGARITA FELSBOURG of 8 LACY STREET SELBY VIC 3159

AQ588949L 28/12/2017

ENCUMBRANCES, CAVEATS AND NOTICES

MORTGAGE AV765874M 21/06/2022

FIRST MORTGAGE COMPANY HOME LOANS PTY LTD

Any encumbrances created by Section 98 Transfer of Land Act 1958 or Section 24 Subdivision Act 1988 and any other encumbrances shown or entered on the plan or imaged folio set out under DIAGRAM LOCATION below.

DIAGRAM LOCATION

SEE CP150144 FOR FURTHER DETAILS AND BOUNDARIES

ACTIVITY IN THE LAST 125 DAYS

NIL

-----END OF REGISTER SEARCH STATEMENT-----

Additional information: (not part of the Register Search Statement)

Street Address: 8 LACY STREET SELBY VIC 3159

ADMINISTRATIVE NOTICES

NIL

eCT Control 20637K LIVE LAWYER PTY LTD

Effective from 21/06/2022

DOCUMENT END



Imaged Document Cover Sheet

The document following this cover sheet is an imaged document supplied by LANDATA®, Secure Electronic Registries Victoria.

Document Type	Plan
Document Identification	CP150144
Number of Pages (excluding this cover sheet)	1
Document Assembled	10/05/2024 16:15

Copyright and disclaimer notice:

© State of Victoria. This publication is copyright. No part may be reproduced by any process except in accordance with the provisions of the Copyright Act 1968 (Cth) and for the purposes of Section 32 of the Sale of Land Act 1962 or pursuant to a written agreement. The information is only valid at the time and in the form obtained from the LANDATA® System. None of the State of Victoria, LANDATA®, Secure Electronic Registries Victoria Pty Ltd (ABN 86 627 986 396) as trustee for the Secure Electronic Registries Victoria Trust (ABN 83 206 746 897) accept responsibility for any subsequent release, publication or reproduction of the information.

The document is invalid if this cover sheet is removed or altered.

PLAN OF CONSOLIDATION OF
PART OF CROWN ALLOTMENT 3^B AND 3^C SECTION A
PARISH OF NARREE WORRAN
COUNTY OF MORNINGTON

CP150144.

EDITION 1

SCALE 10 5 0 10 20
LENGTHS ARE IN METRES

Chart No.5.

V.9101 F.541
V.9369 F.758

NOTATIONS

TOGETHER WITH an easement of
way and drainage over the-
land shown marked B on the map-

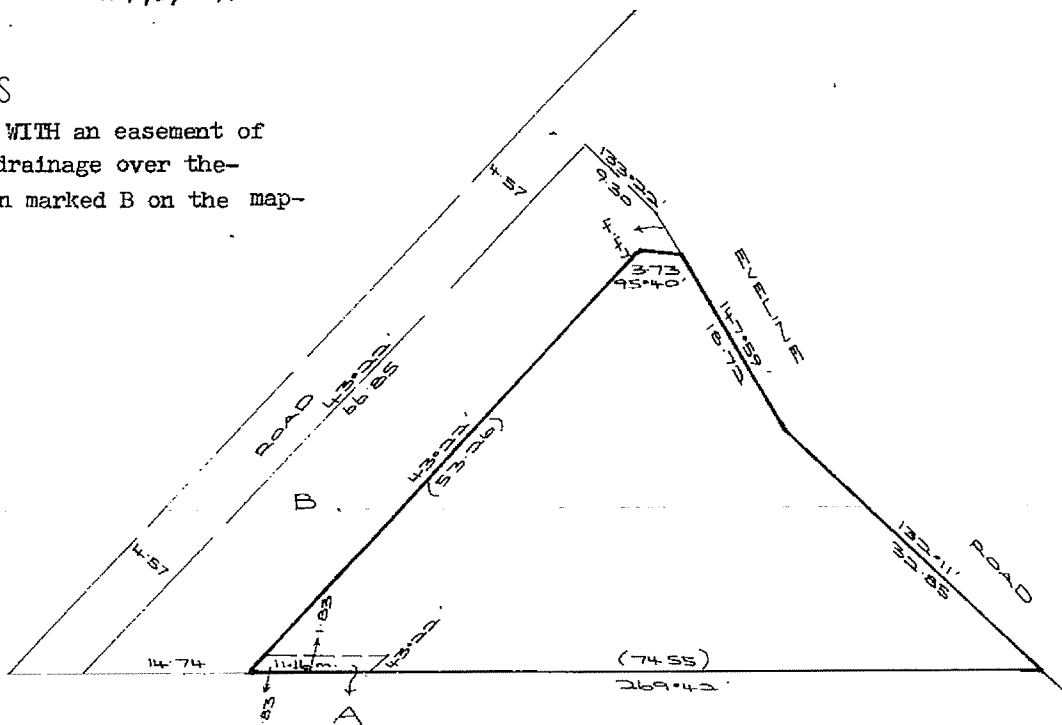

CP
ACCEPT
\$25-00
7/11/2000
9/1/01
H.B. DATA
11/1/50

LIST OF MODIFICATIONS

LAND	MODIFICATION	DEALING No.	A.R.T	EDN. No.
	APPURTENANT RIGHTS ENHANCED			2

ENCUMBRANCES

As to the land shown marked A - - - -

THE DRAINAGE EASEMENTS existing over-
the same by virtue of Section 98 of
the Transfer of Land Act see Plan of
Subdivision No.12355 - - - -

APPROVED

H.J. Macey
17/6/20
9.55

VOL. 9376 F01712

CONSENT OF COUNCIL

Sealed pursuant to Section 569 AB of the Local
Government Act.

The Common Seal of the President,
Councillors and Ratepayers of the
Shire of Sherbrooke is hereby
affixed this 17th day of
MARCH 19th 20th

In the presence of
[Signature] President

[Signature] Councillor

[Signature] Shire Secretary

Council Ref: 3^B/NW-A/14

SURVEYORS CERTIFICATION

I CERTIFY THAT THIS PLAN HAS BEEN
MADE BY H.J.MACEY PTY. LTD AND
ACCORDS WITH TITLE AND IS
MATHEMATICALLY CORRECT.

H.J. Macey
LICENSED SURVEYOR
DATE: 18th FEBRUARY 2000

REF

PLANNING CERTIFICATE

Official certificate issued under Section 199 Planning & Environment Act 1987
and the Planning and Environment Regulations 2005

CERTIFICATE REFERENCE NUMBER

1030227

APPLICANT'S NAME & ADDRESS

BLAAK AND HUYNH LAWYERS C/- INFOTRACK
(SMOKEBALL) C/- LANDATA
DOCKLANDS

VENDOR

FELSBURG, ANDREW AUGUSTIN

PURCHASER

NOT KNOWN, NOT KNOWN

REFERENCE

771889

This certificate is issued for:

PLAN CP150144 ALSO KNOWN AS 8 LACY STREET SELBY
YARRA RANGES SHIRE

The land is covered by the:

YARRA RANGES PLANNING SCHEME

The Minister for Planning is the responsible authority issuing the Certificate.

The land:

- is included in a GREEN WEDGE A ZONE - SCHEDULE 1
- is within a ENVIRONMENTAL SIGNIFICANCE OVERLAY - SCHEDULE 1
- and a SIGNIFICANT LANDSCAPE OVERLAY - SCHEDULE 3
- and a EROSION MANAGEMENT OVERLAY
- and a BUSHFIRE MANAGEMENT OVERLAY
- and is AREA OUTSIDE THE URBAN GROWTH BOUNDARY

A detailed definition of the applicable Planning Scheme is available at :
(<http://planningschemes.dpcd.vic.gov.au/schemes/yarraranges>)

Historic buildings and land protected under the Heritage Act 1995 are recorded in the Victorian
Heritage Register at:
<http://vhf.heritage.vic.gov.au/>

10 May 2024

Sonya Kilkenny
Minister for Planning

Additional site-specific controls may apply.
The Planning Scheme Ordinance should be
checked carefully.
The above information includes all
amendments to planning scheme maps
placed on public exhibition up to the date
of issue of this certificate and which are
still the subject of active consideration

Copies of Planning Schemes and
Amendments can be inspected at the
relevant municipal offices.

LANDATA®
T: (03) 9102 0402
E: landata.enquiries@servictoria.com.au

The attached certificate is issued by the Minister for Planning of the State of Victoria and is protected by statute.

The document has been issued based on the property information you provided. You should check the map below - it highlights the property identified from your information.

If this property is different to the one expected, you can phone (03) 9102 0402 or email landata.enquiries@servictoria.com.au

Please note: The map is for reference purposes only and does not form part of the certificate.

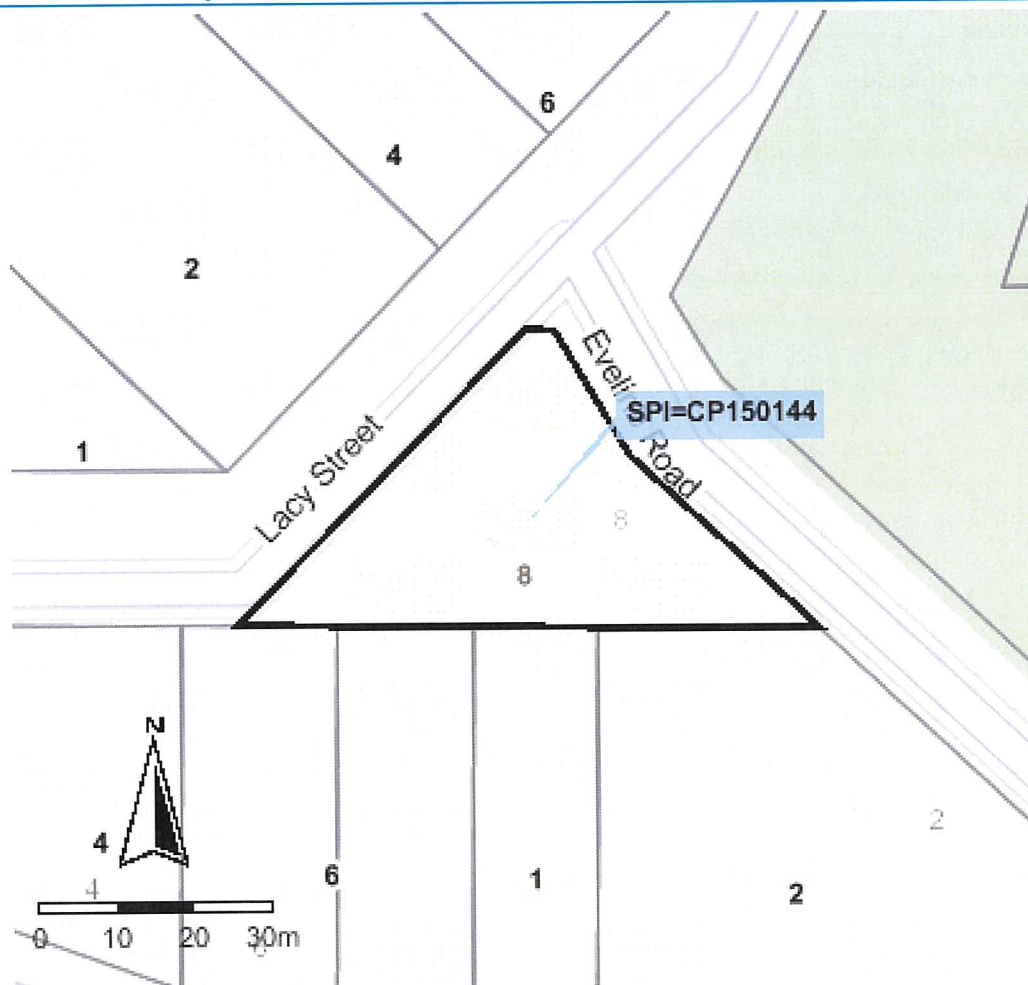

Copyright © State Government of Victoria. Service provided by maps.land.vic.gov.au

Choose the authoritative Planning Certificate

Why rely on anything less?

As part of your section 32 statement, the authoritative Planning Certificate provides you and / or your customer with the statutory protection of the State of Victoria.
Order online before 4pm to receive your authoritative Planning Certificate the same day, in most cases within the hour.
Next business day delivery, if further information is required from you.

Privacy Statement

The information obtained from the applicant and used to produce this certificate was collected solely for the purpose of producing this certificate. The personal information on the certificate has been provided by the applicant and has not been verified by LANDATA®. The property information on the certificate has been verified by LANDATA®. The zoning information on the certificate is protected by statute. The information on the certificate will be retained by LANDATA® for auditing purposes and will not be released to any third party except as required by law.

PLANNING PROPERTY REPORT



From www.planning.vic.gov.au at 28 May 2024 04:32 PM

PROPERTY DETAILS

Address: 8 LACY STREET SELBY 3159
Lot and Plan Number: Plan CP150144
Standard Parcel Identifier (SPI): CP150144
Local Government Area (Council): YARRA RANGES
Council Property Number: 223723
Planning Scheme: Yarra Ranges
Directory Reference: Melway 124 A12

www.yarraranges.vic.gov.au

Planning Scheme - Yarra Ranges

UTILITIES

Rural Water Corporation: Southern Rural Water
Melbourne Water Retailer: Yarra Valley Water
Melbourne Water: Inside drainage boundary
Power Distributor: AUSNET

STATE ELECTORATES

Legislative Council: EASTERN VICTORIA
Legislative Assembly: MONBULK

OTHER

Registered Aboriginal Party: Bunurong Land Council Aboriginal Corporation

View location in VicPlan

Planning Zones

GREEN WEDGE A ZONE (GWAZ)
GREEN WEDGE A ZONE - SCHEDULE 1 (GWAZ1)

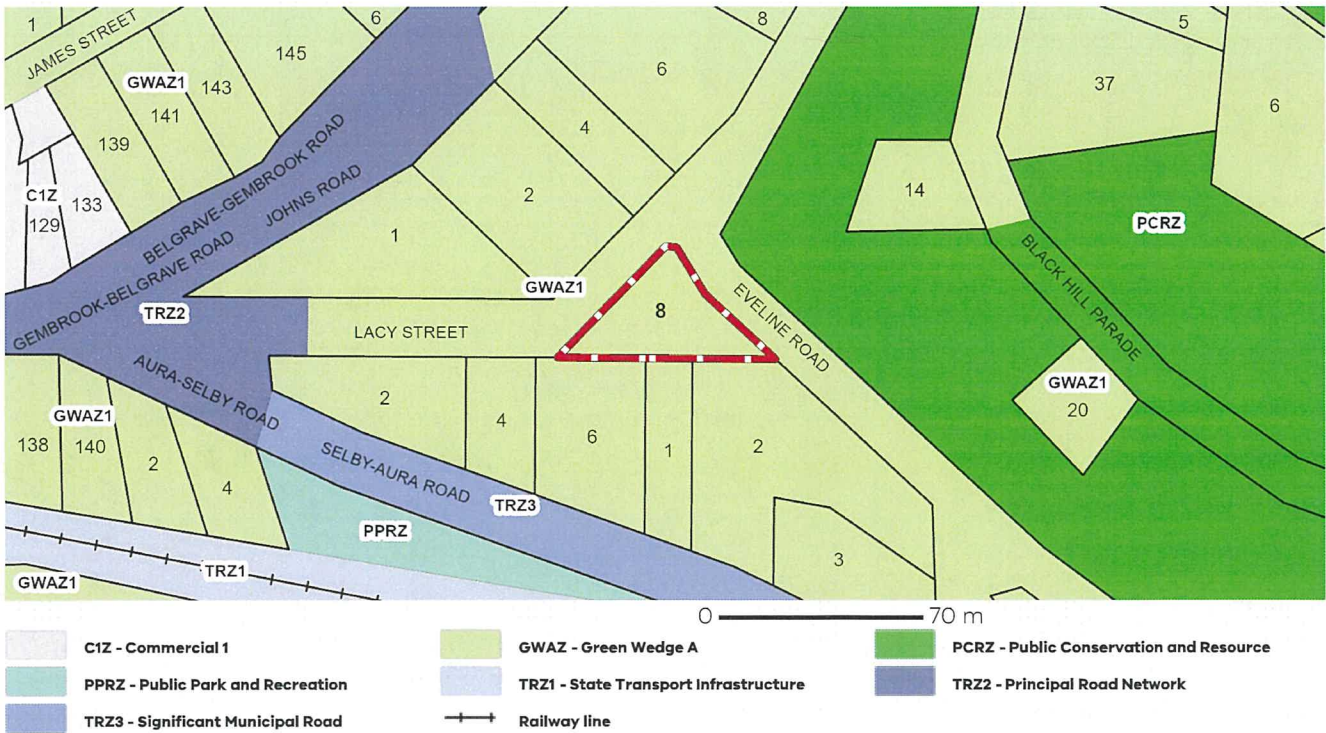

Note: labels for zones may appear outside the actual zone - please compare the labels with the legend.

PLANNING PROPERTY REPORT

Planning Overlays

BUSHFIRE MANAGEMENT OVERLAY (BMO)

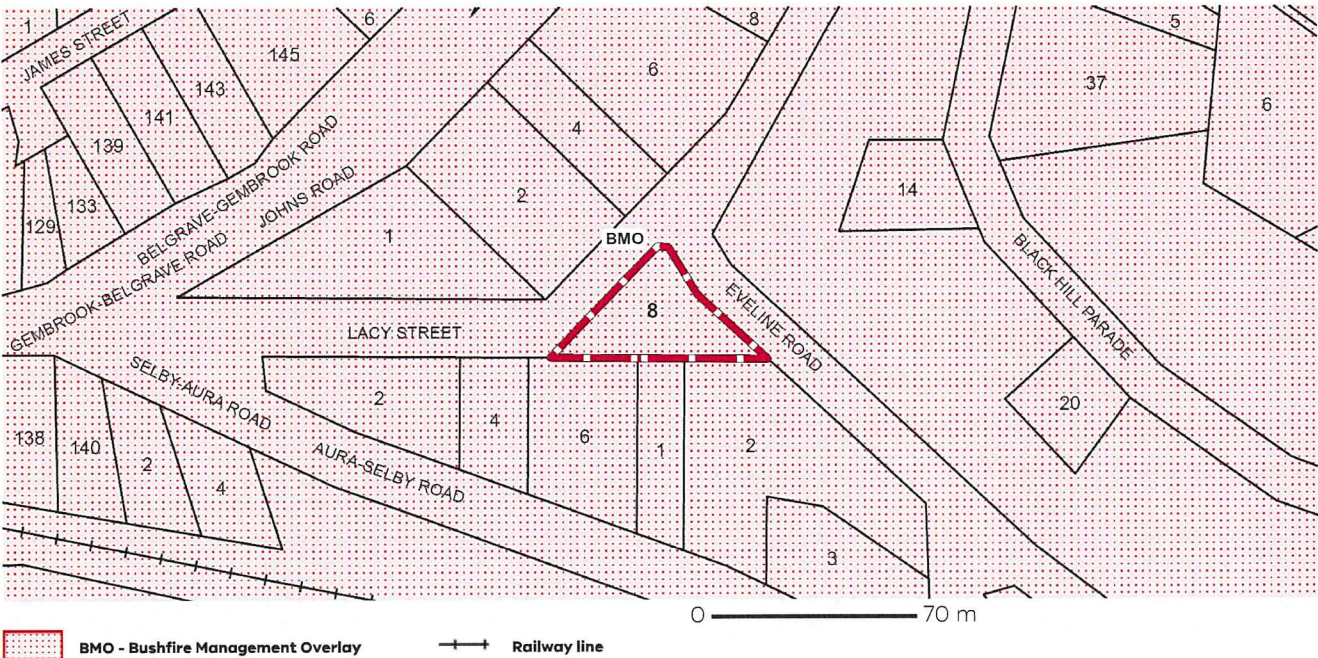

EROSION MANAGEMENT OVERLAY (EMO)

EROSION MANAGEMENT OVERLAY SCHEDULE (EMO)

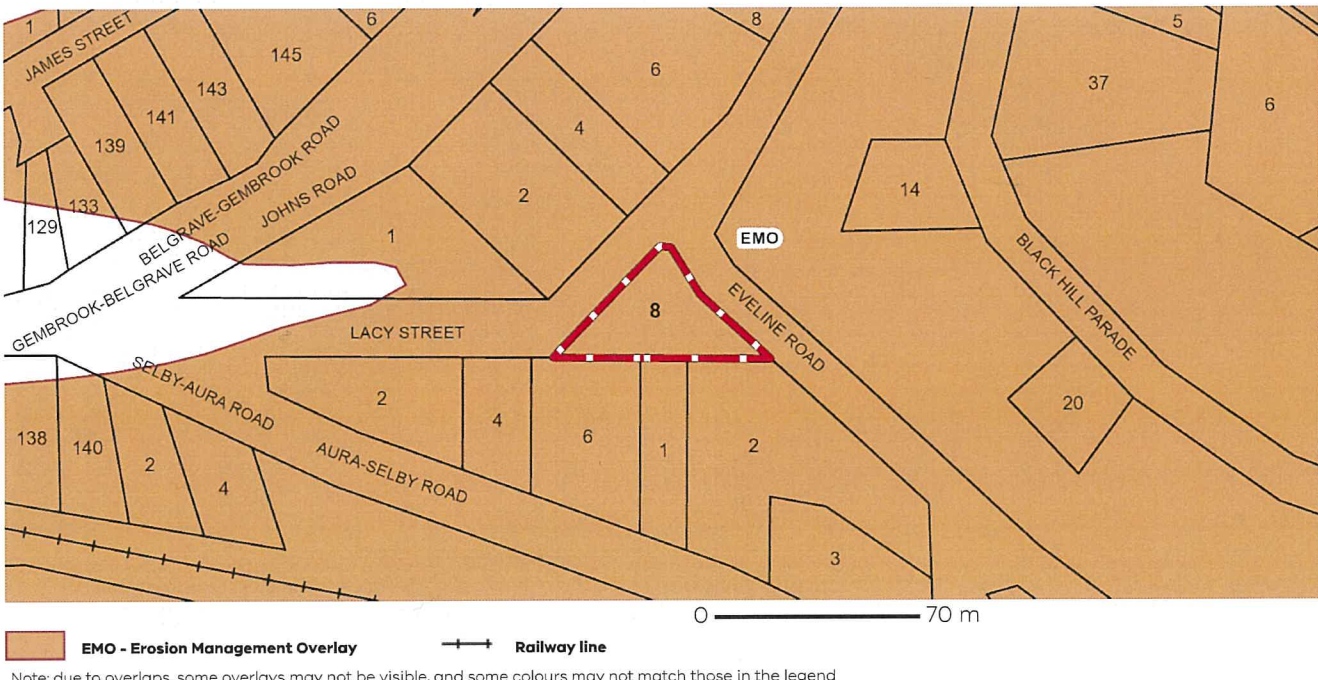

PLANNING PROPERTY REPORT



Environment,
Land, Water
and Planning

Planning Overlays

ENVIRONMENTAL SIGNIFICANCE OVERLAY (ESO)

ENVIRONMENTAL SIGNIFICANCE OVERLAY - SCHEDULE 1 (ESO1)

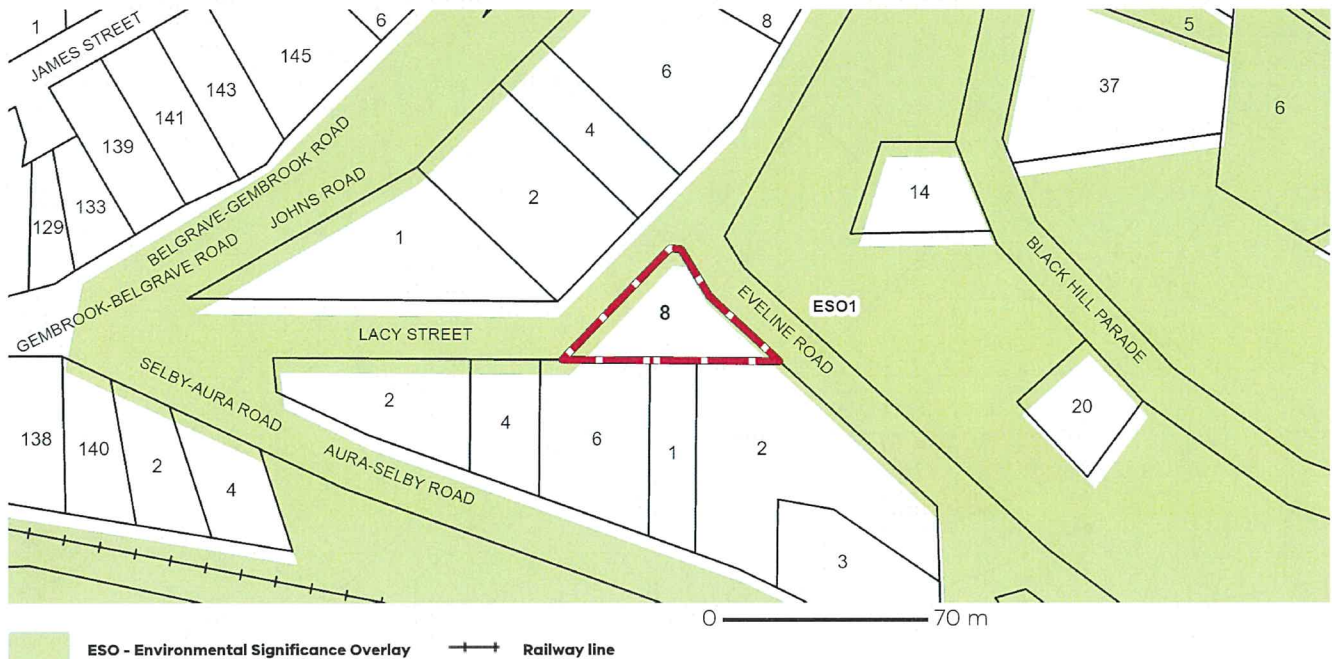

Note: due to overlaps, some overlays may not be visible, and some colours may not match those in the legend

SIGNIFICANT LANDSCAPE OVERLAY (SLO)

SIGNIFICANT LANDSCAPE OVERLAY - SCHEDULE 3 (SLO3)

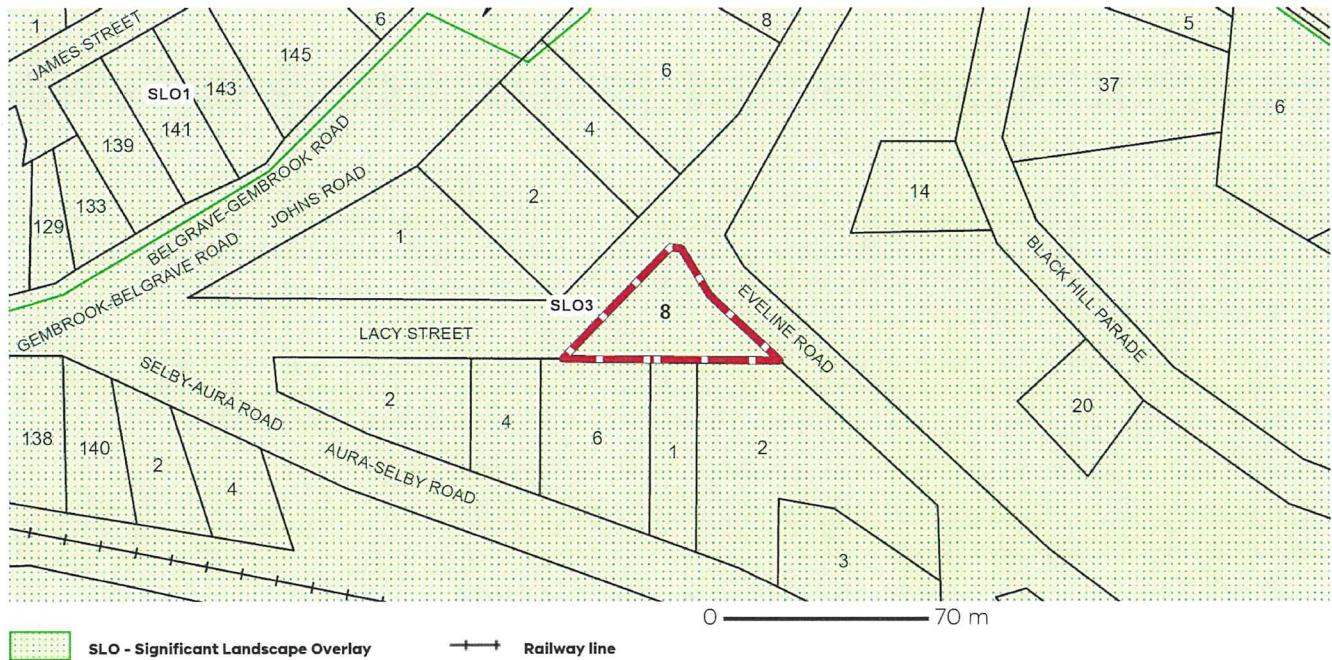

Note: due to overlaps, some overlays may not be visible, and some colours may not match those in the legend

Copyright © - State Government of Victoria

Disclaimer: This content is provided for information purposes only. No claim is made as to the accuracy or authenticity of the content. The Victorian Government does not accept any liability to any person for the information provided. Read the full disclaimer at <https://www.delwp.vic.gov.au/disclaimer>

Notwithstanding this disclaimer, a vendor may rely on the information in this report for the purpose of a statement that land is in a bushfire prone area as required by section 32C (b) of the Sale of Land 1962 (Vic).

PLANNING PROPERTY REPORT



Environment,
Land, Water
and Planning

Planning Overlays

OTHER OVERLAYS

Other overlays in the vicinity not directly affecting this land

HERITAGE OVERLAY (HO)

RESTRUCTURE OVERLAY (RO)

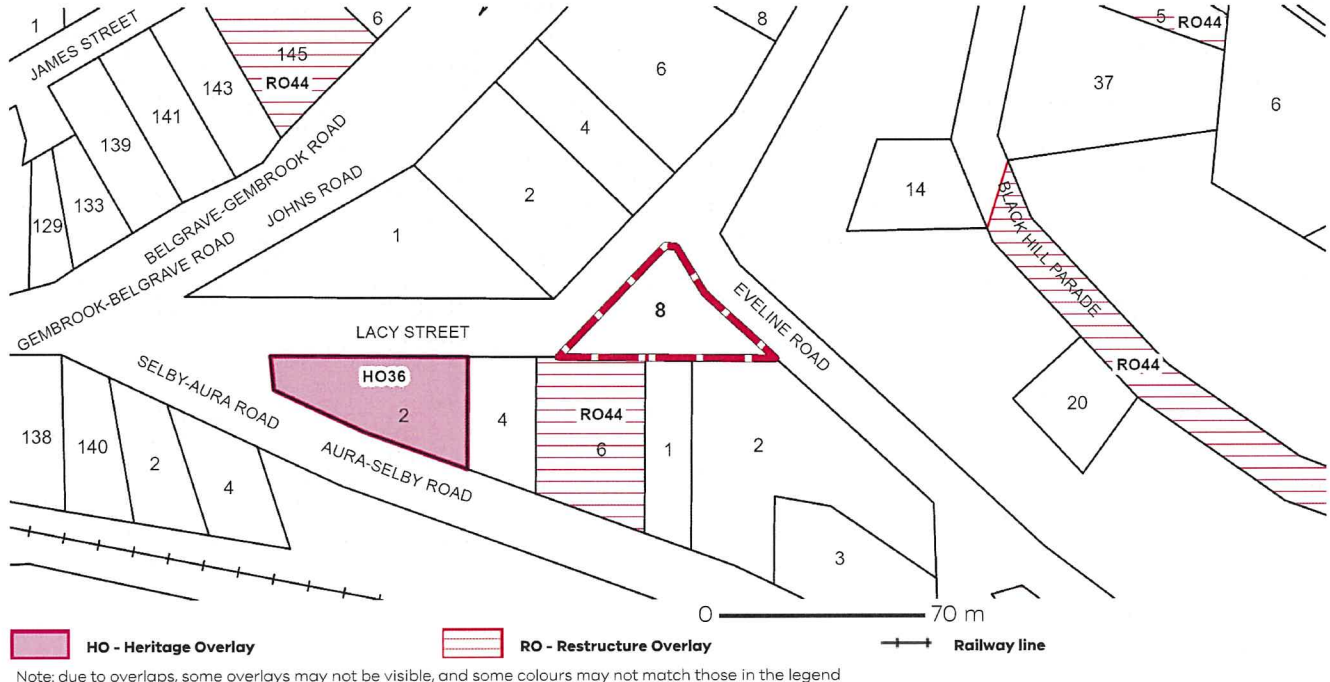

Further Planning Information

Planning scheme data last updated on 22 May 2024.

A **planning scheme** sets out policies and requirements for the use, development and protection of land. This report provides information about the zone and overlay provisions that apply to the selected land. Information about the State and local policy, particular, general and operational provisions of the local planning scheme that may affect the use of this land can be obtained by contacting the local council or by visiting <https://www.planning.vic.gov.au>

This report is NOT a **Planning Certificate** issued pursuant to Section 199 of the **Planning and Environment Act 1987**. It does not include information about exhibited planning scheme amendments, or zonings that may apply to the land. To obtain a Planning Certificate go to Titles and Property Certificates at Landata - <https://www.landata.vic.gov.au>

For details of surrounding properties, use this service to get the Reports for properties of interest.

To view planning zones, overlay and heritage information in an interactive format visit <https://mapshare.maps.vic.gov.au/vicplan>

For other information about planning in Victoria visit <https://www.planning.vic.gov.au>

Copyright © - State Government of Victoria

Disclaimer: This content is provided for information purposes only. No claim is made as to the accuracy or authenticity of the content. The Victorian Government does not accept any liability to any person for the information provided. Read the full disclaimer at <https://www.delwp.vic.gov.au/disclaimer>

Notwithstanding this disclaimer, a vendor may rely on the information in this report for the purpose of a statement that land is in a bushfire prone area as required by section 32C (b) of the Sale of Land 1962 (Vic).

PLANNING PROPERTY REPORT: 8 LACY STREET SELBY 3159

Page 4 of 5

PLANNING PROPERTY REPORT



Environment,
Land, Water
and Planning

Designated Bushfire Prone Areas

This property is in a designated bushfire prone area. Special bushfire construction requirements apply to the part of the property mapped as a designated bushfire prone area (BPA). Planning provisions may apply.

Where part of the property is mapped as BPA, if no part of the building envelope or footprint falls within the BPA area, the BPA construction requirements do not apply.

Note: the relevant building surveyor determines the need for compliance with the bushfire construction requirements.

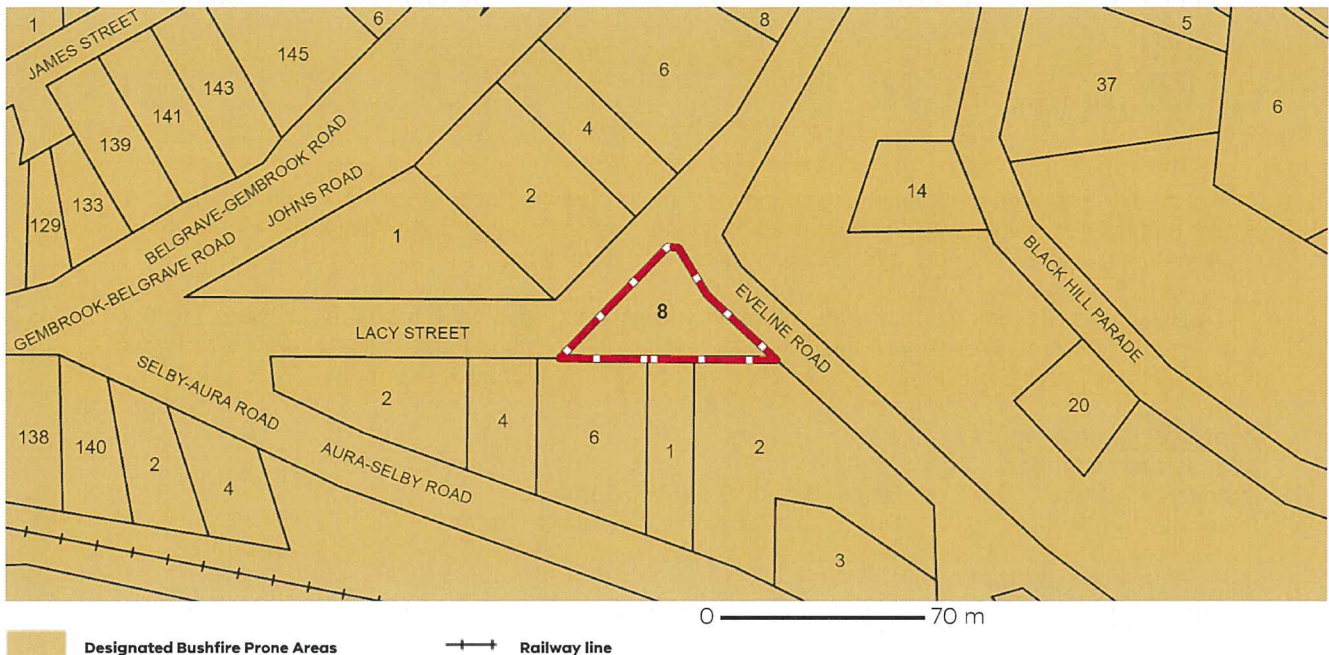

Designated BPA are determined by the Minister for Planning following a detailed review process. The Building Regulations 2018, through adoption of the Building Code of Australia, apply bushfire protection standards for building works in designated BPA.

Designated BPA maps can be viewed on VicPlan at <https://mapshare.vic.gov.au/vicplan/> or at the relevant local council.

Create a BPA definition plan in [VicPlan](#) to measure the BPA.

Information for lot owners building in the BPA is available at <https://www.planning.vic.gov.au>.

Further information about the building control system and building in bushfire prone areas can be found on the Victorian Building Authority website <https://www.vba.vic.gov.au>. Copies of the Building Act and Building Regulations are available from <http://www.legislation.vic.gov.au>. For Planning Scheme Provisions in bushfire areas visit <https://www.planning.vic.gov.au>.

Native Vegetation

Native plants that are indigenous to the region and important for biodiversity might be present on this property. This could include trees, shrubs, herbs, grasses or aquatic plants. There are a range of regulations that may apply including need to obtain a planning permit under Clause 52.17 of the local planning scheme. For more information see [Native Vegetation \(Clause 52.17\)](#) with local variations in [Native Vegetation \(Clause 52.17\) Schedule](#).

To help identify native vegetation on this property and the application of Clause 52.17 please visit the Native Vegetation Information Management system <https://nvim.delwp.vic.gov.au/> and [Native vegetation \(environment.vic.gov.au\)](https://environment.vic.gov.au) or please contact your relevant council.

You can find out more about the natural values on your property through NatureKit [NatureKit \(environment.vic.gov.au\)](https://environment.vic.gov.au)

Copyright © - State Government of Victoria

Disclaimer: This content is provided for information purposes only. No claim is made as to the accuracy or authenticity of the content. The Victorian Government does not accept any liability to any person for the information provided.

Read the full disclaimer at <https://www.delwp.vic.gov.au/disclaimer>

Notwithstanding this disclaimer, a vendor may rely on the information in this report for the purpose of a statement that land is in a bushfire prone area as required by section 32C (b) of the Sale of Land 1962 (Vic).

LAND INFORMATION CERTIFICATE

Section 229 Local Government Act 1989

PO Box 105
Lilydale Vic 3140
Call 1300 368 333
Fax (03) 9735 4249
ABN 21 973 226 012
www.yarraranges.vic.gov.au
mail@yarraranges.vic.gov.au

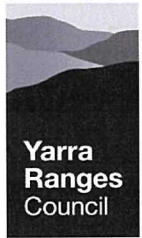

Certificate Number: 114423
Issue Date: 10-May-2024
Applicant Reference: 72785764-015-8:157500

Landata
DX 250639
MELBOURNE VIC

This certificate provides information regarding valuation, rates, charges, other monies owing and any orders and notices made under the Local Government Act 1958, Local Government Act 1989, Local Government Act 2020 or under a local law or by law of the council.

This certificate is not required to include information regarding planning, building, health, land fill, land slip, flooding information or service easements. Information regarding these matters may be available from the council or the relevant authority. A fee may be charged for such information.

PROPERTY INFORMATION

Assessment Number: 61293/4
Property Address: 8 Lacy Street, Selby VIC 3159
Property Description: CP150144 Ca 3DE/35A PNarree Worran

VALUATION INFORMATION

Current Level of Value Date: 1 January 2023
Operative Date of Value: 01-Jul-2023
Site Value: 470,000
Capital Improved Value: 775,000
Net Annual Value: 38,750

FINANCIAL INFORMATION

Rates and Charges Levied Year Ending 30 June 2024		Rates and Charges Summary	
Rate or Charge Type	Annual Charge	Description	Balance Outstanding
General Rates	1,942.80	Legal Charges Arrears	0.00
Waste Charge	444.00	Arrears & Previous Year Interest	0.00
Fire Services Property Levy	160.65	Current Interest on Arrears	0.00
		Interest on Current Rates	0.00
		Current Year Rates	2,547.45
		Rebates	0.00
		Payments since 1 July 2023	-2,264.45
		Overpayment	0.00
		Other	0.00
		Total Rates Outstanding	283.00
		Chargeable Works &/or EUA	0.00
		Local Govt Act 1989—Sec. 227	0.00
Total Annual Charge	2,547.45	Balance Outstanding	\$283.00

Rates are due to be paid in full by 15 Feb 2024, if payment is not being made by instalments.

Payment can be made by:

- BPAY – Biller Code 8979 Reference 612934
- On Council's website at yarraranges.vic.gov.au/payments by Visa or Mastercard using Reference 612934

Certificate Number: 114423
Issue Date: 10-May-2024
Applicant Reference: 72785764-015-8:157500

Page 2 of 2

NOTICES AND ORDERS: There ~~are~~ are no outstanding notices or orders on the land served by Council under the Local Government (Miscellaneous) Act 1958, Local Government Act 1989 or a local law or by-law of Council which still apply as at the date of this Certificate.

Details of any Notice or Order Served.

FLOOD LEVEL: Council has not specified a flood level for this property. However, Council cannot warrant that this property may be/ is not subject to flooding. Melbourne Water may have additional information which is not held by Council, which may reveal this property is subject to flooding. Melbourne Water's flood information can be obtained from metropolitan water authorities. It is therefore recommended that you contact Yarra Valley Water/South East Water for more accurate and detailed information.

There ~~is~~ is no potential liability for rates under the Cultural and Recreational Lands Act 1963.

There ~~is~~ is no potential liability for land to become rateable under Section 173 of the Local Government Act 1989.

There ~~is~~ is no potential liability for land to become rateable under Section 174A of the Local Government Act 1989.

There is no outstanding amount required to be paid for recreational purposes or any transfer of land required to Council for recreational purposes under Section 18 of the Subdivision Act 1988 or the Local Government Act (Miscellaneous) Act 1958

OTHER INFORMATION

While Council does not impose a time limit as to when a certificate may be updated verbally, it should be noted that Council will not be held responsible for any information provided or confirmed verbally. A new certificate could be applied for if this is not satisfactory.

I hereby certify that as at the date of this certificate, the information given is true and correct for the property described.



Jim Stewart

Executive Officer, Property Rating Services Date: 10-May-2024
(Contact Property Rating Services on 1300 368 333 for any enquiries)
Received the sum of \$27.80 being the fee for this Certificate.

BUILDING APPROVAL PARTICULARS

Building Act 1993 BUILDING REGULATIONS 2018 Regulation 51(1)

Certificate Number 121305
Your Reference 72785764-016-5:157499
Date Issued 13 May 2024

Landata
DX 250639
MELBOURNE VIC

Yarra Ranges Council
PO Box 105
Lilydale Vic 3140
DX 34051
Call 1300 368 333
Fax 03 9735 4249
mail@yarraranges.vic.gov.au
www.yarraranges.vic.gov.au



Property Address 8 Lacy Street, Selby VIC 3159
Property Description CP150144 Ca 3DE/35A PNarree Worran
Assessment Number 61293

An examination of Council's records reveals the following building approvals have been issued for the above property in the preceding 10 years and any current notices.

Please direct all enquiries to Building Services on 1300 368 333				
Permit Number	Date issued	Brief Description of Works	Final Inspection	Reg 502(1) Statement, Notices, Order or Certificate
		No record of building approvals granted in preceding 10 years		None

Additional information under Regulation 51(2) can be obtained for an additional fee of \$50.70. This information will include details on whether a property is liable to flooding/designated land or works (uncontrolled overland drainage), subject to significant snowfalls or in a designated termite area.

Received the sum of \$50.70 for this certificate.

George Avramopoulos
Municipal Building Surveyor



NOTES

Smoke Alarms/Sprinkler Systems

The Building Regulations Part 7 Division 2 – Fire Safety in Certain Existing Residential Buildings states that you may be required to provide hard wired smoke alarms and/or automatic fire sprinkler systems in residential buildings.

Note: Smoke Alarms were required to be installed by 1.2.99 or within 30 days of settlement, whichever was the earlier.

Swimming Pools

The Building Regulations requires all swimming pools and spas capable of holding a depth of water exceeding 300mm to be provided with pool fencing/barriers. A building permit is required for any new fencing/barrier or alteration to existing fencing/barrier.



YARRA VALLEY WATER
ABN 93 066 902 501

Lucknow Street
Mitcham Victoria 3132

Private Bag 1
Mitcham Victoria 3132

DX 13204

F (03) 9872 1353

E enquiry@yvw.com.au
yvw.com.au

10th May 2024

Blaak and Huynh Lawyers C/- InfoTrack (Smokeball)
LANDATA

Dear Blaak and Huynh Lawyers C/- InfoTrack (Smokeball) ,

RE: Application for Water Information Statement

Property Address:	8 LACY STREET SELBY 3159
Applicant	Blaak and Huynh Lawyers C/- InfoTrack (Smokeball) LANDATA
Information Statement	30849567
Conveyancing Account Number	7959580000
Your Reference	771889

Thank you for your recent application for a Water Information Statement (WIS). We are pleased to provide you the WIS for the above property address. This statement includes:

- Yarra Valley Water Property Information Statement
- Melbourne Water Property Information Statement
- Asset Plan
- Rates Certificate

If you have any questions about Yarra Valley Water information provided, please phone us on **1300 304 688** or email us at the address propertyflow@yvw.com.au. For further information you can also refer to the Yarra Valley Water website at www.yvw.com.au.

Yours sincerely,

A handwritten signature in black ink, appearing to read 'C Brace'.

Chris Brace
GENERAL MANAGER
RETAIL SERVICES



YARRA VALLEY WATER
ABN 93 066 902 501

Lucknow Street
Mitcham Victoria 3132

Private Bag 1
Mitcham Victoria 3132

DX 13204

F (03) 9872 1353

E enquiry@yvw.com.au
yvw.com.au

Yarra Valley Water Property Information Statement

Property Address	8 LACY STREET SELBY 3159
------------------	--------------------------

STATEMENT UNDER SECTION 158 WATER ACT 1989

THE FOLLOWING INFORMATION RELATES TO SECTION 158(3)

Existing sewer mains will be shown on the Asset Plan. If no assets can be seen, email easyaccess@yvw.com.au to seek servicing options available to the property.

Existing sewer mains will be shown on the Asset Plan.

Please note: Unless prior consent has been obtained, the Water Act prohibits:

1. The erection and/or placement of any building, wall, bridge, fence, embankment, filling, material, machinery or other structure over or under any sewer or drain.
2. The connection of any drain or sewer to, or interference with, any sewer, drain or watercourse.



YARRA VALLEY WATER
ABN 93 066 902 501

Lucknow Street
Mitcham Victoria 3132

Private Bag 1
Mitcham Victoria 3132

DX 13204

F (03) 9872 1353

E enquiry@yvw.com.au
yvw.com.au

Melbourne Water Property Information Statement

Property Address	8 LACY STREET SELBY 3159
------------------	--------------------------

STATEMENT UNDER SECTION 158 WATER ACT 1989

THE FOLLOWING INFORMATION RELATES TO SECTION 158(4)









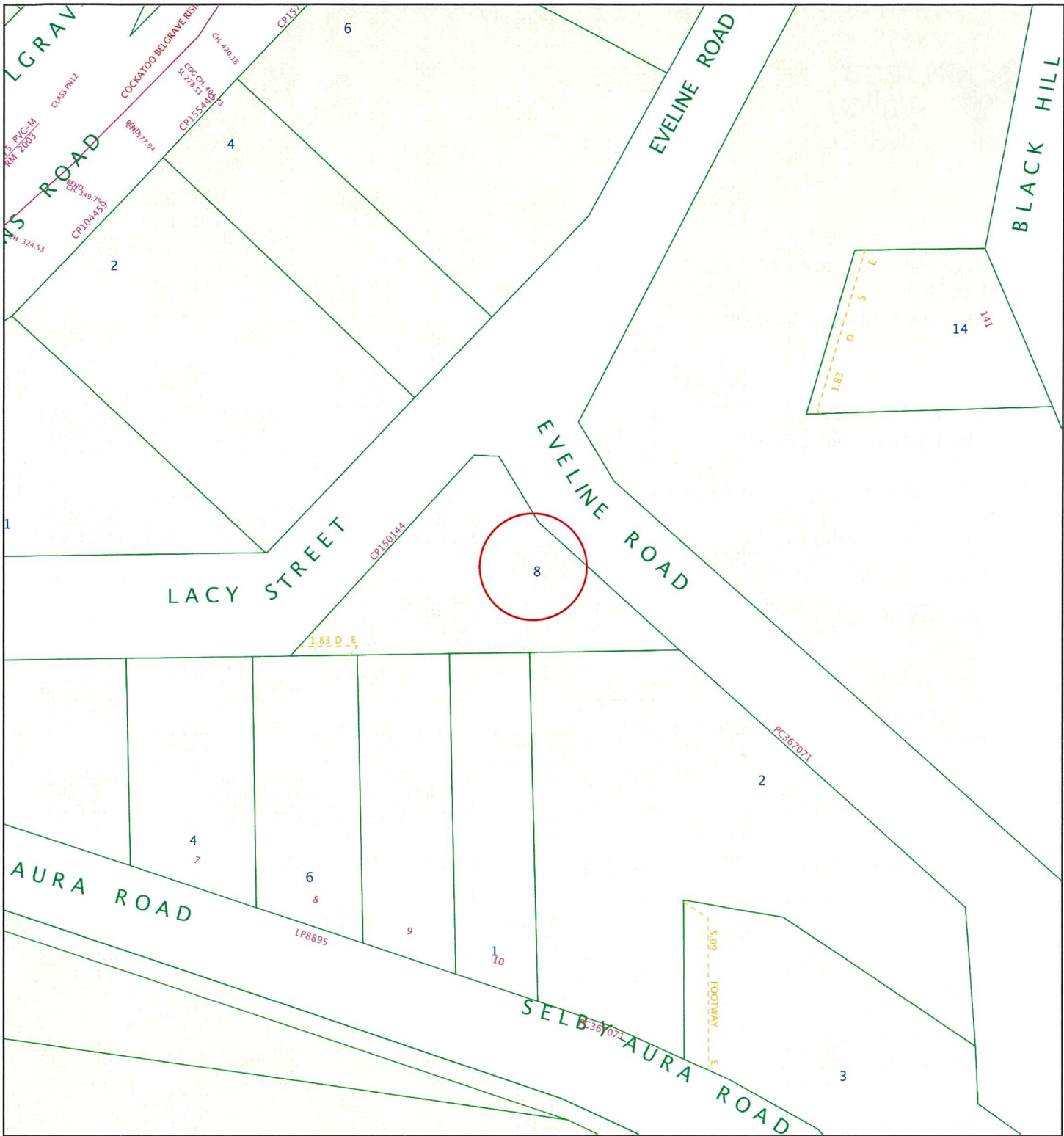





Information available at Melbourne Water indicates that this property is not subject to flooding from Melbourne Water's drainage system, based on a flood level that has a probability of occurrence of 1% in any one year.

Please note: Unless prior consent has been obtained, the Water Act prohibits:

1. The erection and/or placement of any building, wall, bridge, fence, embankment, filling, material, machinery or other structure over or under any sewer or drain.
2. The connection of any drain or sewer to, or interference with, any sewer, drain or watercourse.

If you have any questions regarding Melbourne Water encumbrances or advisory information, please contact Melbourne Water on 9679 7517.



Yarra Valley Water Information Statement Number: 30849567	Address		8 LACY STREET SELBY 3159		 Yarra Valley Water ABN 93 066 902 501	
	Date		10/05/2024			
	Scale		1:1000			
Existing Title		Access Point Number	GLV2-42	MW Drainage Channel Centreline		Disclaimer: This information is supplied on the basis Yarra Valley Water Ltd: - Does not warrant the accuracy or completeness of the information supplied, including, without limitation, the location of Water and Sewer Assets; - Does not accept any liability for loss or damage of any nature, suffered or incurred by the recipient or any other persons relying on this information; - Recommends recipients and other persons using this information make their own site investigations and accommodate their works accordingly;
Proposed Title		Sewer Manhole		MW Drainage Underground Centreline		
Easement		Sewer Pipe Flow		MW Drainage Manhole		
Existing Sewer		Sewer Offset		MW Drainage Natural Waterway		
Abandoned Sewer		Sewer Branch				



YARRA VALLEY WATER
ABN 93 066 902 501

Lucknow Street
Mitcham Victoria 3132

Private Bag 1
Mitcham Victoria 3132

DX 13204

F (03) 9872 1353

E enquiry@yvw.com.au
yvw.com.au

Blaak and Huynh Lawyers C/- InfoTrack (Smokeball)
LANDATA
certificates@landata.vic.gov.au

RATES CERTIFICATE

Account No: 0443030255
Rate Certificate No: 30849567

Date of Issue: 10/05/2024
Your Ref: 771889

With reference to your request for details regarding:

Property Address	Lot & Plan	Property Number	Property Type
8 LACY ST, SELBY VIC 3159		1382178	Residential

Agreement Type	Period	Charges	Outstanding
Parks Fee *	01-04-2024 to 30-06-2024	\$21.10	\$21.10
Drainage Fee	01-04-2024 to 30-06-2024	\$16.13	\$16.13
Other Charges:			
Interest	No interest applicable at this time		
	No further charges applicable to this property		
Balance Brought Forward			\$0.00
Total for This Property			\$37.23

* Please note, from 1 July 2023 the Parks fee will be charged quarterly instead of annually.

GENERAL MANAGER
RETAIL SERVICES

Note:

- From 1 July 2023, the Parks Fee will be charged quarterly instead of annually.
- From 1 July 2023, for properties that have water and sewer services, the Residential Water and Sewer Usage charge replaces the Residential Water Usage and Residential Sewer Usage charges.
- This statement details all tariffs, charges, and penalties due and payable to Yarra Valley Water as of the date of this statement and includes tariffs and charges (other than for usage charges yet to be billed) which are due and payable to the end of the current financial quarter.
- All outstanding debts are due to be paid to Yarra Valley Water at settlement. Any debts that are unpaid at settlement will carry over onto the purchaser's first quarterly account and follow normal credit and collection activities - pursuant to section 275 of the Water Act 1989.
- If the total due displays a (-\$ cr), this means the account is in credit. Credit amounts will be transferred to the purchaser's account at settlement.

6. Yarra Valley Water provides information in this Rates Certificate relating to waterways and drainage as an agent for Melbourne Water and relating to parks as an agent for Parks Victoria - pursuant to section 158 of the Water Act 1989.
7. The charges on this rates certificate are calculated and valid at the date of issue. To obtain up-to-date financial information, please order a Rates Settlement Statement prior to settlement.
8. From 01/07/2023, Residential Water Usage is billed using the following step pricing system: 249.56 cents per kilolitre for the first 44 kilolitres; 318.98 cents per kilolitre for 44-88 kilolitres and 472.56 cents per kilolitre for anything more than 88 kilolitres. From 1 July 2023, this charge is applicable for properties with water service only.
9. From 01/07/2023, Residential Water and Sewer Usage is billed using the following step pricing system: 334.38 cents per kilolitre for the first 44 kilolitres; 438.73 cents per kilolitre for 44-88 kilolitres and 509.73 cents per kilolitre for anything more than 88 kilolitres. From 1 July 2023, this charge is applicable for residential properties with both water and sewer services.
10. From 01/07/2023, Residential Recycled Water Usage is billed 188.71 cents per kilolitre.
11. From 01/07/2022 up to 30/06/2023, Residential Sewer Usage was calculated using the following equation: Water Usage (kl) x Seasonal Factor x Discharge Factor x Price (/kl) 1.1540 per kilolitre. From 1 July 2023, this charge will no longer be applicable for residential customers with both water and sewer services.
12. The property is a serviced property with respect to all the services, for which charges are listed in the Statement of Fees above.



YARRA VALLEY WATER
ABN 93 066 902 501

Lucknow Street
Mitcham Victoria 3132

Private Bag 1
Mitcham Victoria 3132

DX 13204

F (03) 9872 1353

E enquiry@yvw.com.au
yvw.com.au

To ensure you accurately adjust the settlement amount, we strongly recommend you book a Special Meter Reading:

- Special Meter Readings ensure that actual water use is adjusted for at settlement.
- Without a Special Meter Reading, there is a risk your client's settlement adjustment may not be correct.

Property No: 1382178

Address: 8 LACY ST, SELBY VIC 3159

Water Information Statement Number: 30849567

HOW TO PAY



Biller Code: 314567
Ref: 04430302550

**Amount
Paid**

**Date
Paid**

**Receipt
Number**

Property Clearance Certificate
Land Tax



INFOTRACK / BLAAK AND HUYNH LAWYERS

Your Reference: 1447-2024
Certificate No: 76360111
Issue Date: 10 MAY 2024
Enquiries: ESYSPROD

Land Address: 8 LACY STREET SELBY VIC 3159

Land Id	Lot	Plan	Volume	Folio	Tax Payable
26489583		150144	9376	712	\$0.00

Vendor: LOUISA FELSBURG & ANDREW FELSBURG
Purchaser: FOR INFORMATION PURPOSES

Current Land Tax	Year	Taxable Value	Proportional Tax	Penalty/Interest	Total
ANDREW AUGUSTIN FELSBURG	2024	\$470,000	\$0.00	\$0.00	\$0.00

Comments: Property is exempt: LTX Principal Place of Residence.

Current Vacant Residential Land Tax	Year	Taxable Value	Proportional Tax	Penalty/Interest	Total
-------------------------------------	------	---------------	------------------	------------------	-------

Comments:

Arrears of Land Tax	Year	Proportional Tax	Penalty/Interest	Total
---------------------	------	------------------	------------------	-------

This certificate is subject to the notes that appear on the reverse. The applicant should read these notes carefully.

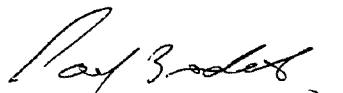
Paul Broderick
Commissioner of State Revenue

CAPITAL IMPROVED VALUE:	\$775,000
SITE VALUE:	\$470,000
CURRENT LAND TAX CHARGE:	\$0.00



Notes to Certificate - Land Tax

Certificate No: 76360111

Power to issue Certificate

1. Pursuant to section 95AA of the *Taxation Administration Act 1997*, the Commissioner of State Revenue must issue a Property Clearance Certificate (Certificate) to an owner, mortgagee or bona fide purchaser of land who makes an application specifying the land for which the Certificate is sought and pays the application fee.

Amount shown on Certificate

2. The Certificate shows any land tax (including Vacant Residential Land Tax, interest and penalty tax) that is due and unpaid on the land described in the Certificate at the date of issue. In addition, it may show:
 - Land tax that has been assessed but is not yet due,
 - Land tax for the current tax year that has not yet been assessed, and
 - Any other information that the Commissioner sees fit to include, such as the amount of land tax applicable to the land on a single holding basis and other debts with respect to the property payable to the Commissioner.

Land tax is a first charge on land

3. Unpaid land tax (including Vacant Residential Land Tax, interest and penalty tax) is a first charge on the land to which it relates. This means it has priority over any other encumbrances on the land, such as a mortgage, and will continue as a charge even if ownership of the land is transferred. Therefore, a purchaser may become liable for any such unpaid land tax.

Information for the purchaser

4. Pursuant to section 96 of the *Land Tax Act 2005*, if a purchaser of the land described in the Certificate has applied for and obtained a certificate, the amount recoverable from the purchaser by the Commissioner cannot exceed the amount set out in the certificate, described as the "Current Land Tax Charge" overleaf. A purchaser cannot rely on a Certificate obtained by the vendor.

Information for the vendor

5. Despite the issue of a Certificate, the Commissioner may recover a land tax liability from a vendor, including any amount identified on this Certificate.

Apportioning or passing on land tax to a purchaser

6. A vendor is prohibited from apportioning or passing on land tax to a purchaser under a contract of sale of land entered into on or after 1 January 2024, where the purchase price is less than \$10 million (to be indexed annually from 1 January 2025, as set out on the website for Consumer Affairs Victoria).

General information

7. A Certificate showing no liability for the land does not mean that the land is exempt from land tax. It means that there is nothing to pay at the date of the Certificate.
8. An updated Certificate may be requested free of charge via our website, if:
 - The request is within 90 days of the original Certificate's issue date, and
 - There is no change to the parties involved in the transaction for which the Certificate was originally requested.

For Information Only

LAND TAX CALCULATION BASED ON SINGLE OWNERSHIP

Land Tax = \$1,860.00

Taxable Value = \$470,000

Calculated as \$1,350 plus (\$470,000 - \$300,000) multiplied by 0.300 cents.

Land Tax - Payment Options

BPAY



Billor Code:5249
Ref: 76360111

Telephone & Internet Banking - BPAY®

Contact your bank or financial institution to make this payment from your cheque, savings, debit or transaction account.

www.bpay.com.au

CARD



Ref: 76360111

Visa or Mastercard

Pay via our website or phone 13 21 61.
A card payment fee applies.

sro.vic.gov.au/paylandtax

Property Clearance Certificate

Windfall Gains Tax



INFOTRACK / BLAAK AND HUYNH LAWYERS

Your Reference: 1447-2024

Certificate No: 76360111

Issue Date: 10 MAY 2024

Land Address: 8 LACY STREET SELBY VIC 3159

Lot	Plan	Volume	Folio
	150144	9376	712

Vendor: LOUISA FELSBURG & ANDREW FELSBURG

Purchaser: FOR INFORMATION PURPOSES

WGT Property Id	Event ID	Windfall Gains Tax	Deferred Interest	Penalty/Interest	Total
		\$0.00	\$0.00	\$0.00	\$0.00

Comments: No windfall gains tax liability identified.

This certificate is subject to the notes that appear on the reverse. The applicant should read these notes carefully.

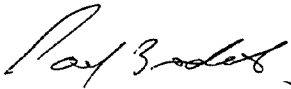

Paul Broderick
Commissioner of State Revenue

CURRENT WINDFALL GAINS TAX CHARGE:

\$0.00



Notes to Certificate - Windfall Gains Tax

Certificate No: 76360111

Power to issue Certificate

1. Pursuant to section 95AA of the *Taxation Administration Act 1997*, the Commissioner of State Revenue must issue a Property Clearance Certificate (Certificate) to an owner, mortgagee or bona fide purchaser of land who makes an application specifying the land for which the Certificate is sought and pays the application fee.

Amount shown on Certificate

2. The Certificate shows in respect of the land described in the Certificate:
- Windfall gains tax that is due and unpaid, including any penalty tax and interest
 - Windfall gains tax that is deferred, including any accrued deferral interest
 - Windfall gains tax that has been assessed but is not yet due
 - Windfall gains tax that has not yet been assessed (i.e. a WGT event has occurred that rezones the land but any windfall gains tax on the land is yet to be assessed)
 - Any other information that the Commissioner sees fit to include such as the amount of interest accruing per day in relation to any deferred windfall gains tax.

Windfall gains tax is a first charge on land

3. Pursuant to section 42 of the *Windfall Gains Tax Act 2021*, windfall gains tax, including any accrued interest on a deferral, is a first charge on the land to which it relates. This means it has priority over any other encumbrances on the land, such as a mortgage, and will continue as a charge even if ownership of the land is transferred. Therefore, a purchaser may become liable for any unpaid windfall gains tax.

Information for the purchaser

4. Pursuant to section 42 of the *Windfall Gains Tax Act 2021*, if a bona fide purchaser for value of land applies for and obtains a Certificate in respect of the land, the maximum amount recoverable from the purchaser by the Commissioner is the amount set out in the certificate, described as the "Current Windfall Gains Tax Charge" overleaf.
5. If the certificate states that a windfall gains tax is yet to be assessed, note 4 does not apply.
6. A purchaser cannot rely on a Certificate obtained by the vendor.

Information for the vendor

7. Despite the issue of a Certificate, the Commissioner may recover a windfall gains tax liability from a vendor, including any amount identified on this Certificate.

Passing on windfall gains tax to a purchaser

8. A vendor is prohibited from passing on a windfall gains tax liability to a purchaser where the liability has been assessed under a notice of assessment as at the date of the contract of sale of land or option agreement. This prohibition does not apply to a contract of sale entered into before 1 January 2024, or a contract of sale of land entered into on or after 1 January 2024 pursuant to the exercise of an option granted before 1 January 2024.

General information

9. A Certificate showing no liability for the land does not mean that the land is exempt from windfall gains tax. It means that there is nothing to pay at the date of the Certificate.
10. An updated Certificate may be requested free of charge via our website, if:
- The request is within 90 days of the original Certificate's issue date, and
 - There is no change to the parties involved in the transaction for which the Certificate was originally requested.
11. Where a windfall gains tax liability has been deferred, interest accrues daily on the deferred liability. The deferred interest shown overleaf is the amount of interest accrued to the date of issue of the certificate.

Windfall Gains Tax - Payment Options

<div><p>BPAY</p><div><div><p>Billers Code: 416073</p><p>Ref: 76360114</p></div></div><p>Telephone & Internet Banking - BPAY®</p><p>Contact your bank or financial institution to make this payment from your cheque, savings, debit or transaction account.</p><p>www.bpay.com.au</p></div>	<div><p>CARD</p><div><div><p>Ref: 76360114</p></div></div><p>Visa or Mastercard</p><p>Pay via our website or phone 13 21 61. A card payment fee applies.</p><p>sro.vic.gov.au/payment-options</p></div>	<div><p>Important payment information</p><p>Windfall gains tax payments must be made using only these specific payment references.</p><p>Using the incorrect references for the different tax components listed on this property clearance certificate will result in misallocated payments.</p></div>
---	--	---



**** Delivered by the LANDATA® System, Department of Environment, Land, Water & Planning ****

ROADS PROPERTY CERTIFICATE

The search results are as follows:

Blaak and Huynh Lawyers C/- InfoTrack (Smokeball)
135 King Street
SYDNEY 2000
AUSTRALIA

Client Reference: 771889

NO PROPOSALS. As at the 10th May 2024, VicRoads has no approved proposals requiring any part of the property described in your application. You are advised to check your local Council planning scheme regarding land use zoning of the property and surrounding area.

This certificate was prepared solely on the basis of the Applicant-supplied address described below, and electronically delivered by LANDATA®.

8 LACY STREET, SELBY 3159
SHIRE OF YARRA RANGES

This certificate is issued in respect of a property identified above. VicRoads expressly disclaim liability for any loss or damage incurred by any person as a result of the Applicant incorrectly identifying the property concerned.

Date of issue: 10th May 2024

Telephone enquiries regarding content of certificate: 13 11 71

[Vicroads Certificate] # 72785764 - 72785764161045 '771889'

